

SfAR-S-16DI-M



Modbus I/O Module

MODEL	DESCRIPTION
SfAR-S-16DI-M	Modbus I/O module with 16 digital inputs with FRAM memory for saving counters' data



APPLICATION AND USE

SfAR-S-16DI-M is a controller's I/O extension, which, thanks to its unique features, fits a variety of applications, for example, counting pulse signals from flowmeters. The module has 16 digital inputs (DI). Digital inputs can work as fast pulse counters with up to 1000 counts per second, or timers measuring the ON state and offering a possibility to connect 2 encoders. The SfAR-S-16DI-M module comes with a FRAM memory, allowing a user to save states of counters or timers in case of power loss. Digital inputs support both PNP and NPN input types. All inputs are isolated from the RS485 and power supply. A built-in RS485 interface allows an easy connection over the Modbus RTU/ASCII protocol. A 32-bit ARM core processor provides fast processing and communication. The module is equipped with a set of LEDs used to indicate the status of I/Os, power supply, and RS485 communication. Configuration of the module is carried out with our free software, the SfAR Configurator. A built-in mini USB allows for performing a primary configuration of the unit without an additional power supply. The module has been equipped with the Quick Connector system to simplify installation. Using a dedicated SfAR-S-LINK cable allows for connecting up to 10 modules, which provide both RS485 communication and an external power supply.

FEATURES

- 16 opto-isolated digital inputs
- Every DI can work as a 32-bit pulse counter or a timer
- Support for 2 encoders
- Non-volatile FRAM memory for counters
- Built-in LEDs for device status indication
- Modbus RTU/ASCII communication
- Baud rate: 2400-115200 bps
- Up to 128 modules on the bus
- Built-in mini USB type B port for configuration
- Space-saving housing
- DIN rail mounting
- DIP switch for configuration
- Quick Connector for grouping modules and providing power and communication

TECHNICAL SPECIFICATION

DESCRIPTION		SfAR-S-16DI-M
Power supply	Voltage	10-38 V DC; 10-28 V AC
Digital input	Number of inputs	8
	Type	PNP or NPN transistor inputs Fast pulse counter up to 1 kHz Timer Encoder support

The performances stated in this sheet can be modified without any prior notice.

DESCRIPTION		SfAR-S-16DI-M
TX	RS485 interface	Up to 128 devices
	Communication protocol	Modbus RTU/ASCII
	Ports	3-pin screw connector
	Baud rate	2400-115200 bps
USB	mini USB	Type B, for configuration
Ingress protection	IP rating	IP 40 for indoor installation
Temperature	Storage	-40°C to +85°C (-40°F to +185°F)
	Operating	-10°C to +50°C (14°F to 122°F)
Humidity	Relative	5 to 95% RH (without condensation)
	Type	2-pin (power supply), 3-pin (RS485), 10-pin (I/O)
Screw connectors	Maximum cable size	2.5 mm ² (18...12 AWG)
	Material	Self-extinguishing plastic (PC/ABS)
Housing	Cooling	Internal air circulation
	Mounting	DIN (DIN EN 50022 norm)
	Width	119.10 mm/4.69 in
Dimensions	Length	101.00 mm/3.98 in
	Height	22.70 mm/0.89 in

WIRING DIAGRAMS

Power Supply

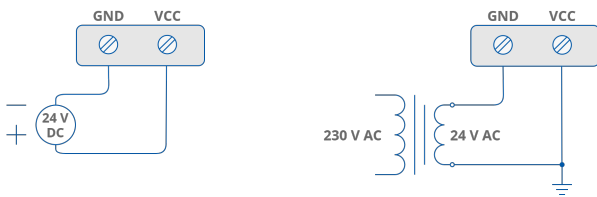

Communication

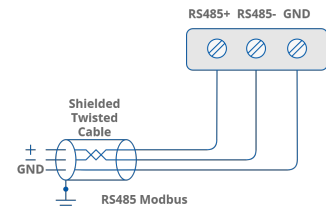

Digital Input

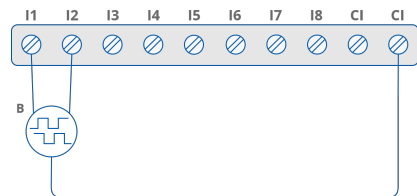
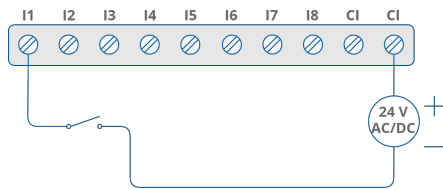

DEDICATED SOFTWARE



SfAR Configurator - Windows-based freeware configuration tool made for Modbus I/O modules

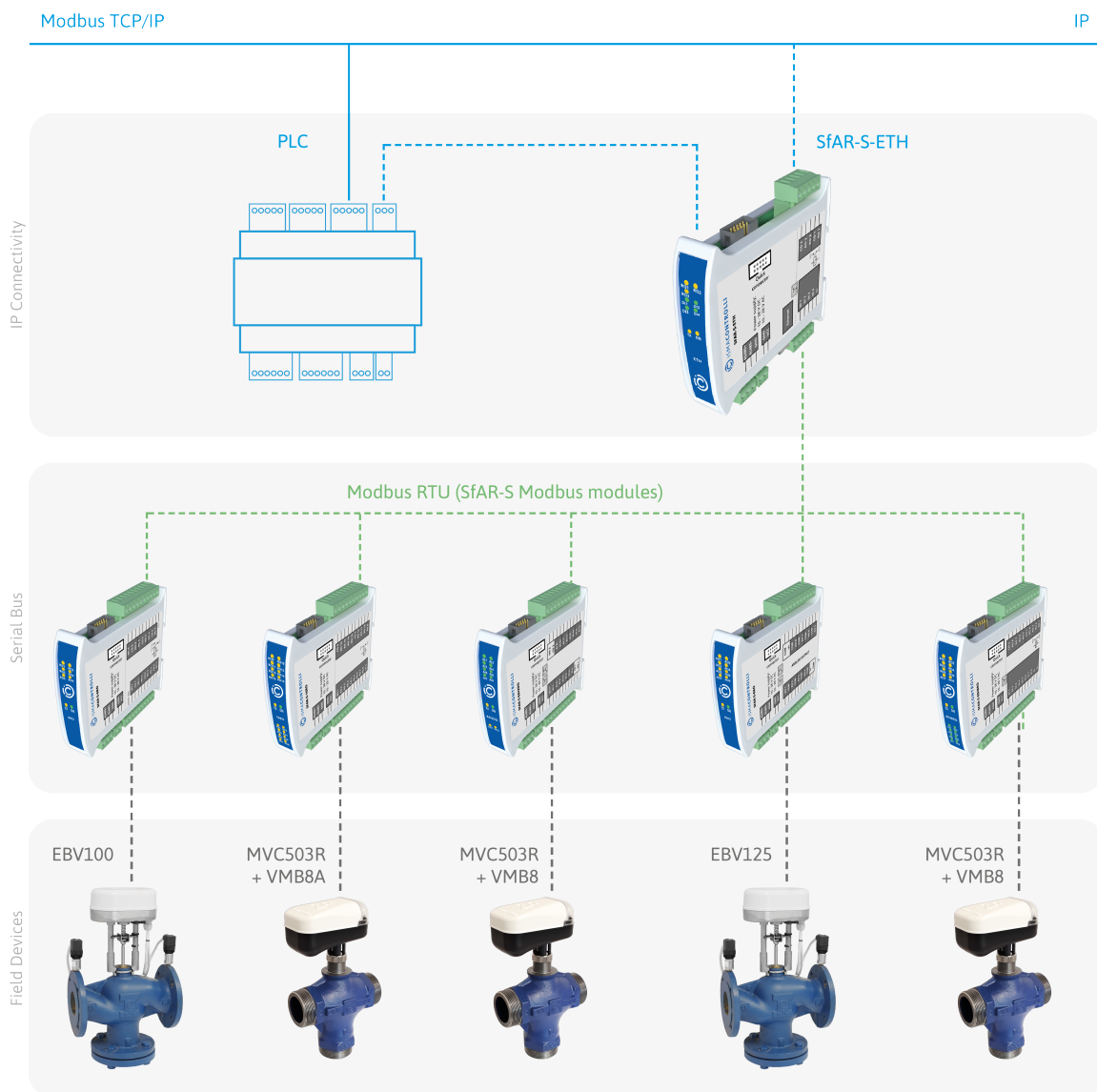

DIMENSIONS [mm]

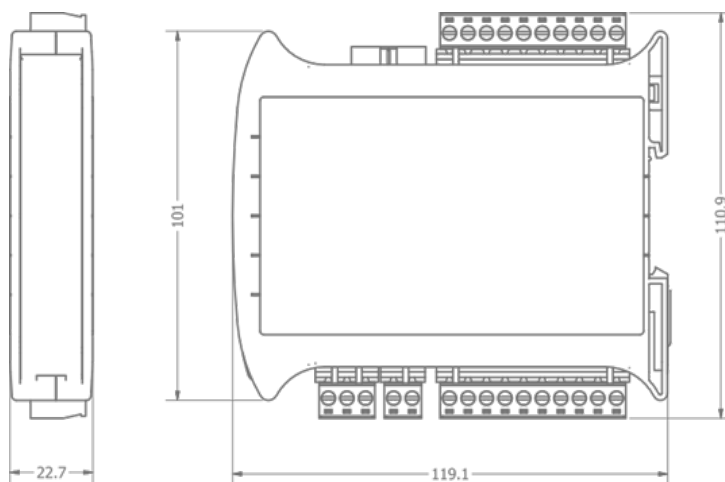

QUICKLINK SOLUTIONS S.r.l. | info@qlsol.com
 Sede operativa nord ovest: Via G. Matteotti 193-203, 21044 Cavaria con Premezzo (VA), Italy
 Sede operativa nord est: Via F. Petrarca, 34, 35020 Albignasego (PD), Italy